

## Support - *Task Lights on MyGripLight*

If for any reason you experience difficulty with your light, please thoroughly read the trouble shooting information provided under the topics below **before you seek to return the product**. Typically, products that are experiencing difficulty are not defective and there is an easy solution for restoring the product to excellent working condition.

### Replace Batteries

With fresh Lithium Cells, your MyGripLight should produce light fairly well for about 40 hours. The light will not be as bright at the end of this time period as it is at the beginning. For optimum light performance, fresh batteries are required.

**Your MyGripLight requires two common 3 Volt cell CR 2032 batteries.**

**Retail Battery Purchase:** To purchase 2032 Lithium Cells, we recommend any of the drug store chains, convenience or grocery stores.

### Instructions:

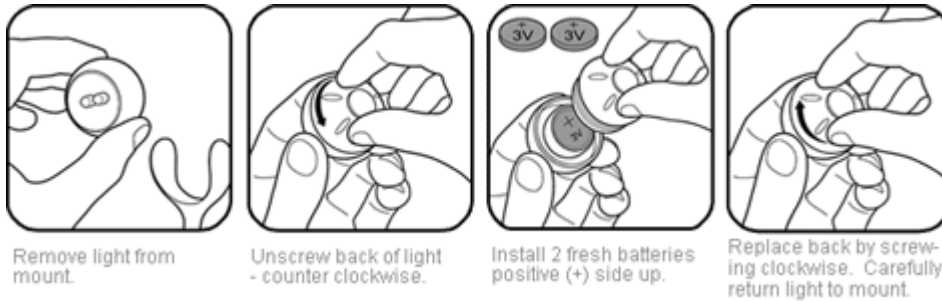

### Tips

When batteries are installed, make sure the (+) and the (-) sides of the batteries are oriented correctly.

### Troubleshooting

#### Dim Light

Your light should arrive with new batteries that have plenty of power to make the LEDs appear **VERY** bright. With good batteries, the LED light should appear almost too bright to look into directly. As the batteries decline due to use, the intensity of the LED brightness will eventually begin to diminish. On average, it should take between 20 to 30 cumulative hours of use before the LED light becomes noticeably dimmer. Even at this point, looking directly into the lights will appear very bright, but will increasingly appear less and less bright with continued use.

Weak batteries will produce less light but will not harm the LEDs. New batteries will correct dimness of light.

### **No Light - or Intermittent Light**

If your light fails to come on when the button on the back is pressed, the batteries should always first be suspected of being depleted. Fresh cells should be purchased and installed into the light.

Like all "flashlights" your MyGripLight relies on metal contacts to distribute power from the batteries to the LED lights. If for any reason, the contacts in your light are hampered by corrosion, or misalignment the LEDs will likely fail to light. It is recommended that you unscrew the back of the light, remove and inspect the batteries and metal contacts for corrosion and proper alignment. If the metal contacts appear misaligned, try gently bending the metal contact on the inside of the back housing of the light inward. Contact and power to the lights should be restored.

### **Flickering Light**

You may experience some slight flickering of the LED bulbs from time to time. Typically, fresh batteries will stop this occurrence.

Flickering may also be a sign of poor registration of the internal metal contacts or corrosion, please see the "No Light" section above.